

Maryland State Archives

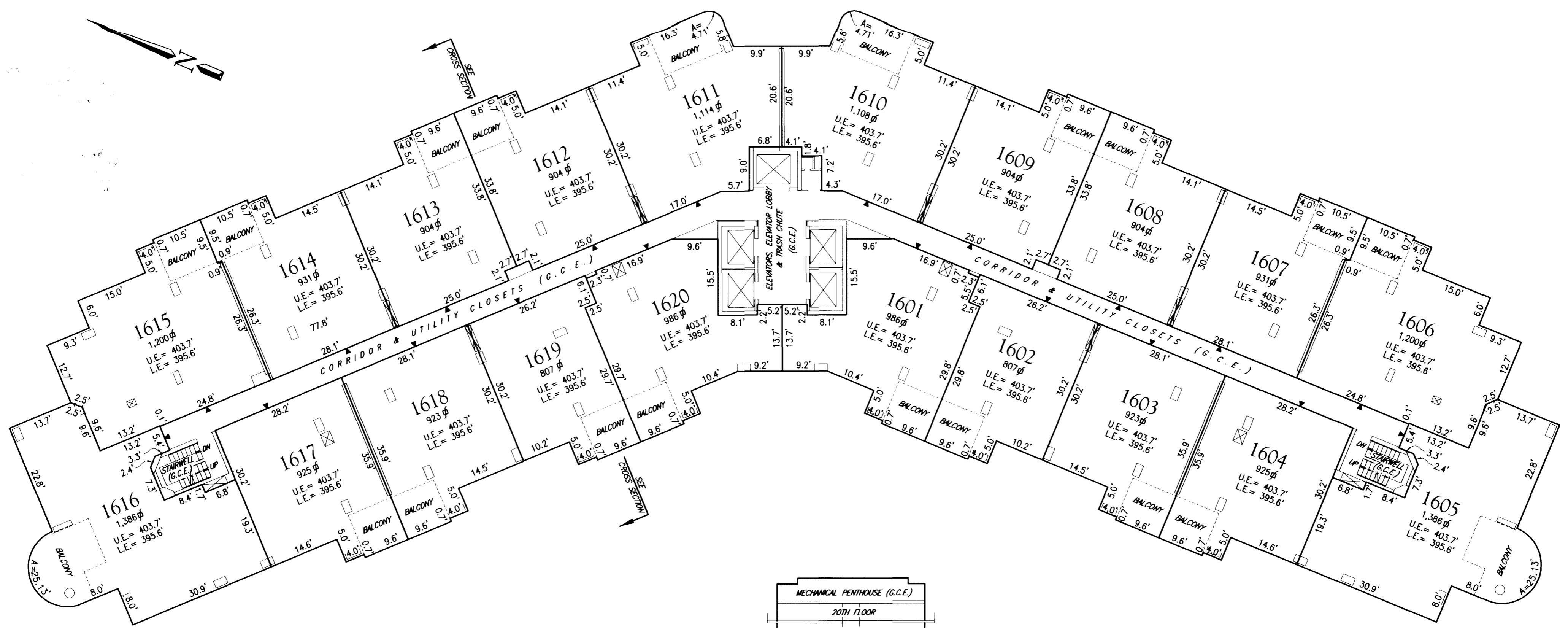

NOTES:

1. EACH CONDOMINIUM UNIT SHOWN HEREON IS DESIGNATED BY A NUMBER. A TYPICAL EXAMPLE IS 1605.
2. UNIT BOUNDARIES ARE SHOWN THUS: _____
 "UNIT" MEANS A THREE-DIMENSIONAL AREA, AS DESCRIBED BELOW AND AS SHOWN ON THE CONDOMINIUM PLAT, AND INCLUDES ALL IMPROVEMENTS CONTAINED WITHIN SUCH AREA EXCEPT SUCH IMPROVEMENTS AS ARE EXPRESSLY EXCLUDED IN THE DECLARATION OR ON THE CONDOMINIUM PLAT. THE LOWER BOUNDARY OF ANY UNIT IS A HORIZONTAL PLANE (OR PLANES), THE ELEVATION OF WHICH COINCIDES WITH THE ELEVATION OF THE UPPER SURFACE OF THE CONCRETE FLOOR SURFACE EXTENDED TO INTERSECT THE LATERAL OR PERIMETRICAL BOUNDARIES THEREOF. THE UPPER BOUNDARY OF EACH RESIDENTIAL UNIT IS A HORIZONTAL PLANE (OR PLANES), THE ELEVATION OF WHICH COINCIDES WITH THE UPPER (UNEXPOSED) SURFACE OF THE UNFINISHED WALLBOARD OF THE UPPERMOST CEILING IN THE UNIT, EXTENDED TO INTERSECT THE LATERAL OR PERIMETRICAL BOUNDARIES THEREOF. THE LATERAL OR PERIMETRICAL BOUNDARIES OF ANY UNIT IS A VERTICAL PLANE (OR PLANES) WHICH COINCIDES WITH THE OUTERMOST (UNEXPOSED) SURFACES OF THE WALLS THAT CONSTITUTE THE BUILDING EXTERIOR, INCLUDING THE WINDOWS AND DOORS THEREOF, EXTENDED TO INTERSECT THE UPPER AND LOWER HORIZONTAL BOUNDARIES THEREOF AND TO INTERSECT THE OTHER LATERAL OR PERIMETRICAL BOUNDARIES OF THE UNIT. THE LATERAL OR PERIMETRICAL BOUNDARY OF A UNIT DESIGNED OR INTENDED TO CONSTITUTE THE BOUNDARY BETWEEN TWO SEPARATE CONTIGUOUS UNITS SHALL COINCIDE WITH THE CENTER LINE OF THE PARTY WALL(S) BETWEEN SUCH UNITS. UNLESS OTHERWISE DESIGNATED IN THIS DECLARATION OR ON THE CONDOMINIUM PLAT AS A COMMON ELEMENT, THE FOLLOWING SHALL BE CONSIDERED A PART OF A UNIT: (I) ANY MECHANICAL EQUIPMENT, FIXTURES AND APPURTENANCES LOCATED WITHIN OR OUTSIDE OF A UNIT AND DESIGNATED TO SERVE ONLY THAT UNIT, SUCH AS PIPES, WIRES, CABLES, CONDUITS, ELECTRICAL RECEPTACLES AND OUTLETS, DUCTS, FLUES, CHUTES, APPLIANCES AND THE LIKE, AND (II) ANY TERRACES AND BALCONIES DESIGNATED TO SERVE ONLY THAT UNIT.
3. ▶ DESIGNATES A UNIT ENTRANCE.
4. □ ⊗ DESIGNATES BEARING WALLS, COLUMNS, DUCTS, SHAFTS, ETC. (NOT ALL ARE SHOWN).
5. G.C.E. = GENERAL COMMON ELEMENTS WHICH SHALL CORRESPOND TO ALL THE PROPERTY SHOWN EXCEPT THE UNITS AND THE LIMITED COMMON ELEMENTS, IF ANY.
6. U.E. = UPPER ELEVATION COINCIDES WITH UPPER UNIT BOUNDARY.
 L.E. = LOWER ELEVATION COINCIDES WITH LOWER UNIT BOUNDARY.
7. FIELD MEASUREMENTS FOR THE UNITS SHOWN HEREON WERE TAKEN TO THE EXPOSED SURFACE OF THE PERIMETER WALLS OF EACH UNIT. ARCHITECTURAL PLANS FOR THE BUILDING WERE USED TO CALCULATE THE POSITION OF THE UNIT BOUNDARIES AS DESCRIBED ABOVE AND IN THE DECLARATION.

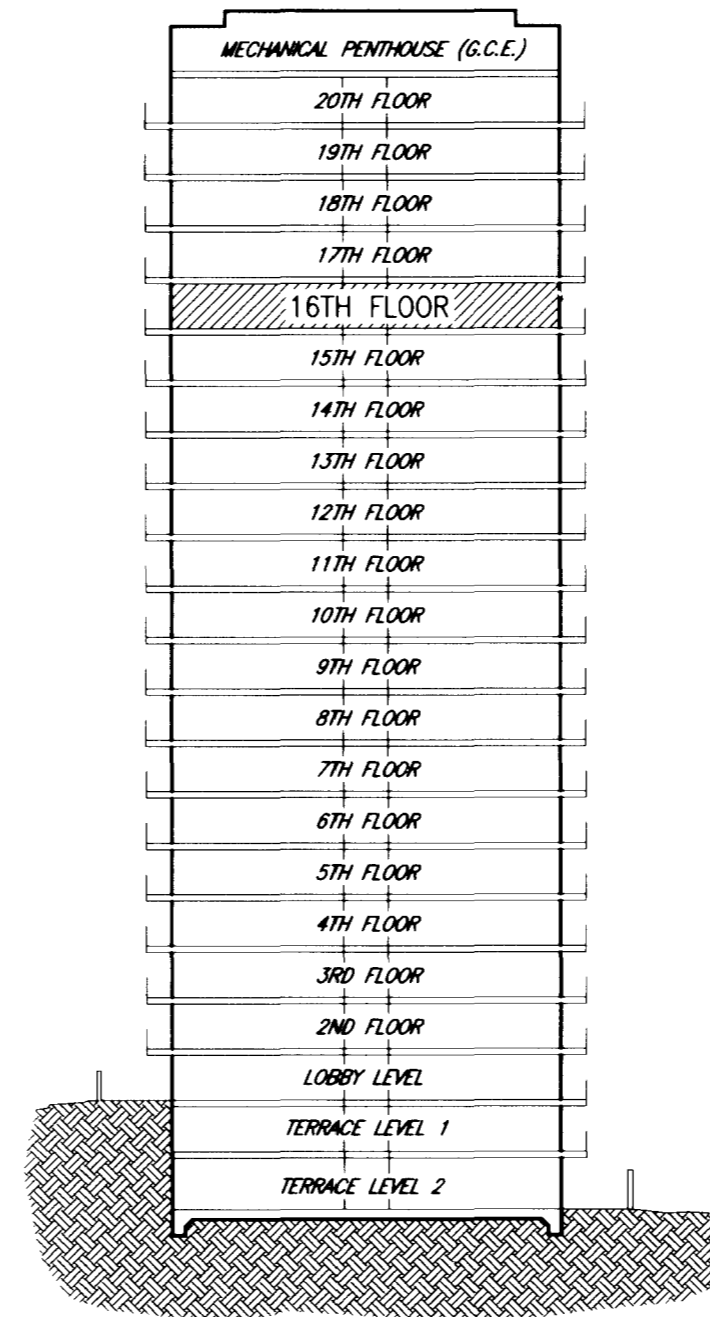

CROSS SECTION
(NOT TO SCALE)

FILED
 OCT 14 2005
 Clerk of the Circuit Court
 Montgomery County, Md.

CONDOMINIUM PLAT
 UNIT PLAN
 16TH FLOOR

**10101 GROSVENOR
 PARK CONDOMINIUM**

ROCKVILLE (4TH) DISTRICT
 MONTGOMERY COUNTY, MARYLAND

OCTOBER, 2005 SCALE: 1"=15'

CPJ Charles P. Johnson & Associates, Inc.
 PLANNERS - ENGINEERS - LANDSCAPE ARCHITECTS - SURVEYORS
 10000 ROCKVILLE PIKE, SUITE 400, ROCKVILLE, MARYLAND 20850
 (301) 761-1100 FAX (301) 761-1101

01133416 MDA SSN 1261-7120-19